



How to use GADD Dashboard Translation

Published 2014-08
gaddsoftware.com

Table of content

| | | |
|--------|----------------------------|---|
| 1. | Introduction..... | 3 |
| 2. | Dashboard Translation..... | 3 |
| 2.1. | Configuration..... | 3 |
| 2.1.1. | Preferred language..... | 4 |

1. Introduction

This document contains guidance on how to use GADD Dashboard Translation.

2. Dashboard Translation

The translation feature allows the static texts in dashboards to be translated into the end users preferred language.

In general it's the headlines and the filter settings that are possible to translate. The red arrows in the picture below show the texts that are possible to translate using this feature. The actual data is not possible to translate using this feature, please consult the documentation on Language specific tables/views.

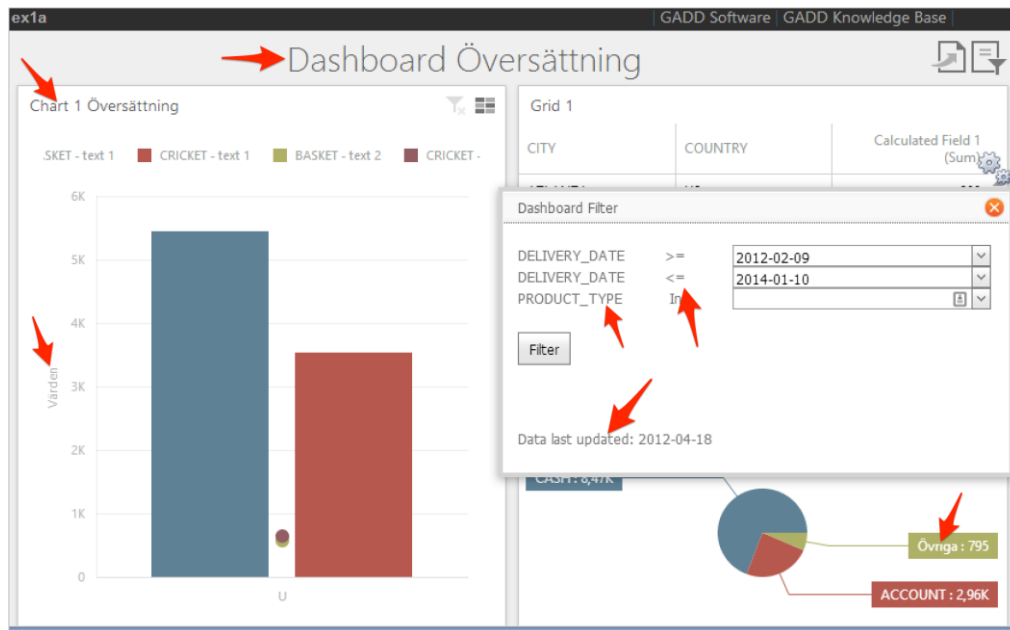

2.1. Configuration

The translation files should be placed in folder

/App_Data/Dashboards/<site name>/translations/

The file name should be the ISO 2 character language code plus a .txt suffix (SV.txt, NN.txt).

The textfile should contain one original text and translation text, tab separated on each row, e.g.

original text 1 translated text 1

original text 2 translated text 2

See more about configuring the translation in chapter Site configuration and the sample project.xml file. This is an excerpt from a SV.txt translation file,

| | |
|------------------|-------------------------------|
| <i>Values</i> | <i>Värden</i> |
| <i>Others</i> | <i>Övriga</i> |
| <i>Dashboard</i> | <i>Dashboard Översättning</i> |
| <i>Chart 1</i> | <i>Chart 1 Översättning</i> |
| <i>COUNTRY</i> | <i>Land</i> |

2.1.1. Preferred language

The users preferred language is decided by the browsers language settings.

To change the language in Google Chrome open the menu->Settings-> Show advanced settings->Language and Input settings

Move or add the language you want to use to the top of the list.

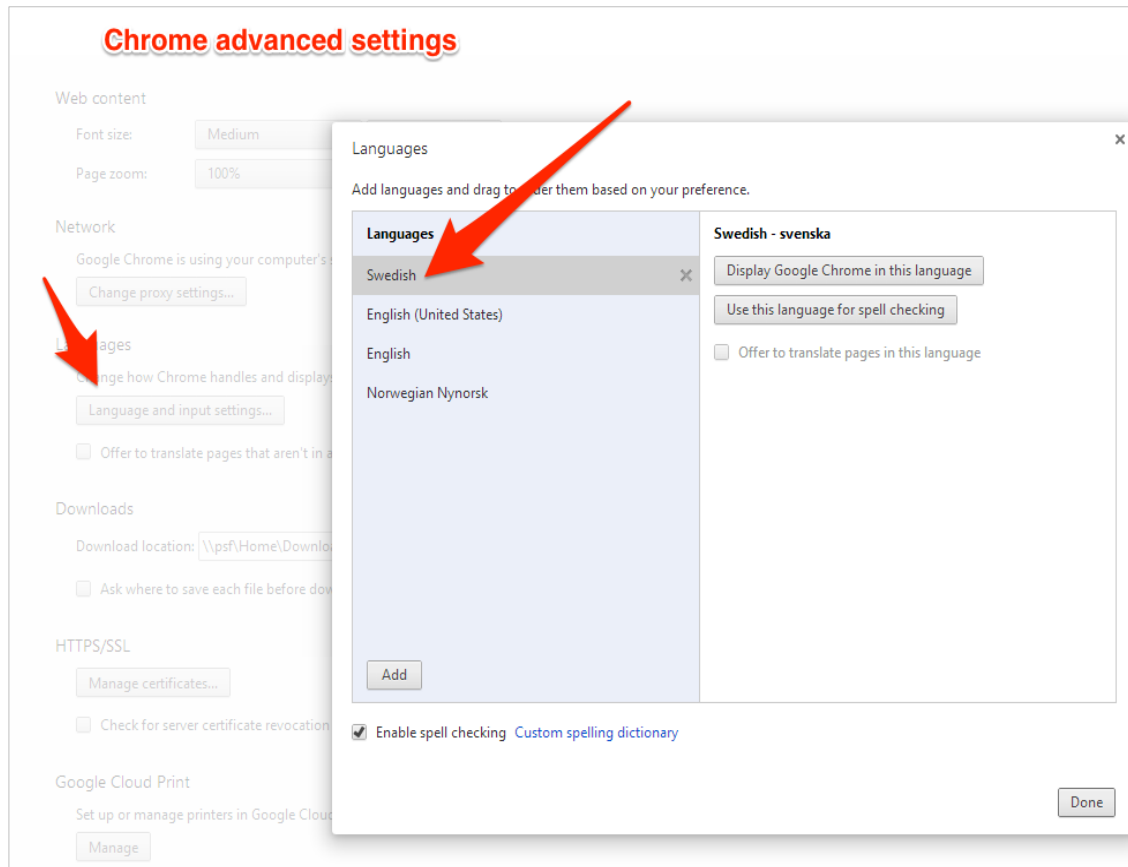

The language setting should take effect after a refresh (F5 or Ctrl-R) but be aware that once a dashboard is loaded it will cache all the translations (default 5 minutes). To reload the translation cache, the web.config has to be touched (saved) or web server has to be restarted.